

Applications



High temperature sensor



- ◆ Stainless steel housing
- ◆ IP67
- ◆ Temperature-resistant up to 120°C
- ◆ Multiple choice - Q8x8, M08, M12, M18, M30
- ◆ Suitable for steel manufacturing, special machine tools, construction machinery, food and beverage industries, etc.

ELCO Industrie Automation GmbH
Benzstrasse 7
71720 Oberstenfeld
Deutschland
E-Mail: info@elco-automation.de



www.elco-automation.de

C+R Automations- GmbH
Nürnberger Straße 45
90513 Zirndorf

Tel. +49 (0)911 656587-0
E-Mail: info@crautomation.de
www.crautomation.de



Technical Data

Type	FI1.5-MQ08-OP6L-Q8/T120 / FI2-MQ08-OP6L-Q8/T120
Rated operating distance S_n	1.5 mm / 2 mm
Mounting condition	Flush
Output function	3-wire, NO contact, PNP
Assured sensing range	$\leq (0,81 \times S_n)$ mm
Correction factors	$S_{I37}=1, V_{2A} \sim 0.7, A_I \sim 0.3$
Hysteresis	3...15%
Temperaturdrift	10%
Ambient temperature	-25...+120°C
Operating voltage	10...30VDC
Residual ripple	$\leq 10\%$ U_b
DC rated operational current	≤ 200 mA
No-load current	≤ 15 mA
Smallest operating current	≤ 1 mA
Residual current	≤ 0.1 mA
Voltage drop	≤ 2.5 V
Rated insulation voltage	≤ 0.5 kV
Short-circuit protection	Yes
Reverse polarity protection	Yes
Switching frequency	1000Hz
Dimensions	8x8x50mm
Housing material	Cu
Material active face	Plastic
Connection	Male, M8
Protection class	IP67
Indication of the switching state	LED,red
Compliance with standards and directives	EN 60947-5-2:2007 IEC 60947-5-2:2007

Dimensions:

Fig.1

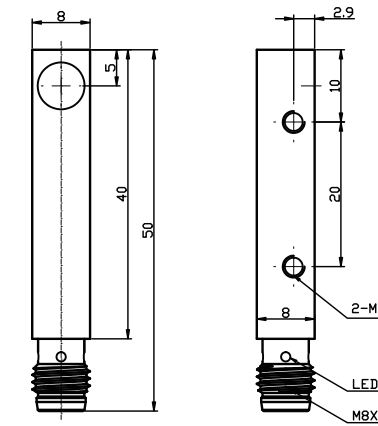

Connection Diagram

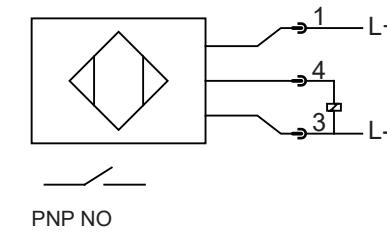

<< Inductive Sensor

FI2-KM08-OP6L-Q8/T120

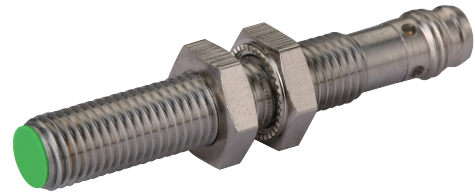

Technical Data

Type	FI2-KM08-OP6L-Q8/T120
Rated operating distance S_n	2mm
Mounting condition	Flush
Output function	3-wire, NO contact, PNP
Assured sensing range	$\leq (0,81 \times S_n)$ mm
Correction factors	$S_{I37}=1, V_{2A} \sim 0.7, A_I \sim 0.3$
Hysteresis	3...15%
Temperaturdrift	10%
Ambient temperature	-25...+120°C
Operating voltage	10...30VDC
Residual ripple	$\leq 10\%$ U_b
DC rated operational current	≤ 200 mA
No-load current	≤ 15 mA
Smallest operating current	≤ 1 mA
Residual current	≤ 0.1 mA
Voltage drop	≤ 2.5 V
Rated insulation voltage	≤ 0.5 kV
Short-circuit protection	Yes
Reverse polarity protection	Yes
Switching frequency	1000Hz
Dimensions	8x8x50mm
Housing material	stainless steel
Material active face	Plastic
Connection	Male, M8
Protection class	IP67
Indication of the switching state	LED,red
Compliance with standards and directives	EN 60947-5-2:2007 IEC 60947-5-2:2007

Dimensions:

Fig.1

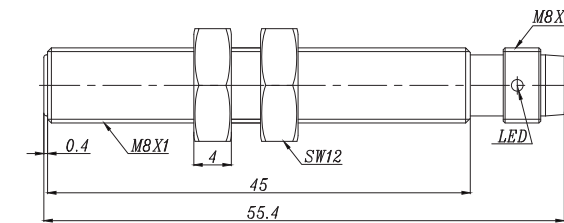

Connection Diagram

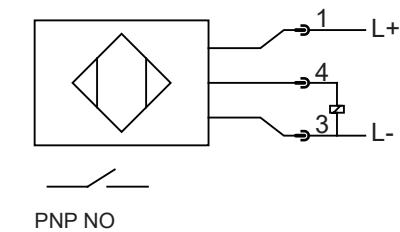

C+R Automations- GmbH

Nürnberger Straße 45
90513 Zirndorf

Tel. +49 (0)911 656587-0
E-Mail: info@crautomation.de
www.crautomation.de

<< Inductive Sensor

Temperature Extension - High Temperature-M08



Description:

Brass nickel-plated, threaded barrel, DC 2-wire output, temperature range up to 120 °C, IP67 protection class, LED indicator.

See the wiring diagram on page 233-234 for your reference.

Technical Data:

Type	Rated Operating Distance S _n	Mounting	Output	Voltage Range U _b	Rated Current	Switching Frequency	Ambient Temperature	Connection	Fig
Fi2-M08-OD6L/T120	2mm	Flush	DC NO	10...30VDC	≤100mA	1000Hz	-25...120°C	2m cable	Fig.1
Fi2-M08-CD6L/T120	2mm	Flush	DC NC	10...30VDC	≤100mA	1000Hz	-25...120°C	2m cable	Fig.1
Ni4-M08-OD6L/T120	4mm	Non-flush	DC NO	10...30VDC	≤100mA	800Hz	-25...120°C	2m cable	Fig.2
Ni4-M08-CD6L/T120	4mm	Non-flush	DC NC	10...30VDC	≤100mA	800Hz	-25...120°C	2m cable	Fig.2

Dimensions:

Fig.1

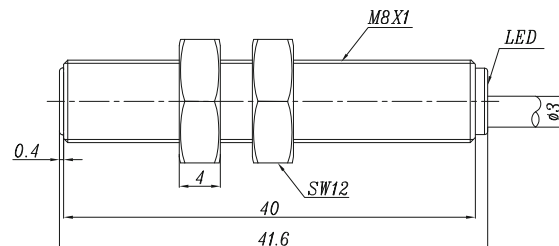
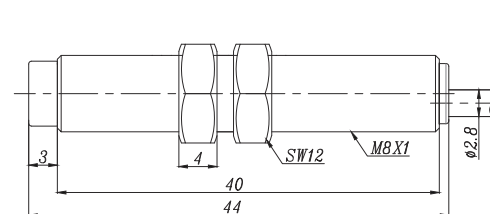

Fig.2



Temperature Extension - High Temperature-M08



Description:

Brass nickel-plated, threaded barrel, DC 3-wire output, temperature range up to 120 °C, IP67 protection class, LED indicator.

See the wiring diagram on page 233-234 for your reference.

Technical Data:

Type	Rated Operating Distance S _n	Mounting	Output	Voltage Range U _b	Rated Current	Switching Frequency	Ambient Temperature	Connection	Fig
Fi2-M08-OP6L/T120	2mm	Flush	PNP NO	10...30VDC	≤100mA	1000Hz	-25...120°C	2m cable	Fig.1
Fi2-M08-ON6L/T120	2mm	Flush	NPN NO	10...30VDC	≤100mA	1000Hz	-25...120°C	2m cable	Fig.1
Fi2-M08-CP6L/T120	2mm	Flush	PNP NC	10...30VDC	≤100mA	1000Hz	-25...120°C	2m cable	Fig.1
Fi2-M08-CN6L/T120	2mm	Flush	NPN NC	10...30VDC	≤100mA	1000Hz	-25...120°C	2m cable	Fig.1
Ni4-M08-OP6L/T120	4mm	Non-flush	PNP NO	10...30VDC	≤100mA	800Hz	-25...120°C	2m cable	Fig.2
Ni4-M08-ON6L/T120	4mm	Non-flush	NPN NO	10...30VDC	≤100mA	800Hz	-25...120°C	2m cable	Fig.2
Ni4-M08-CP6L/T120	4mm	Non-flush	PNP NC	10...30VDC	≤100mA	800Hz	-25...120°C	2m cable	Fig.2
Ni4-M08-CN6L/T120	4mm	Non-flush	NPN NC	10...30VDC	≤100mA	800Hz	-25...120°C	2m cable	Fig.2

Dimensions:

Fig.1

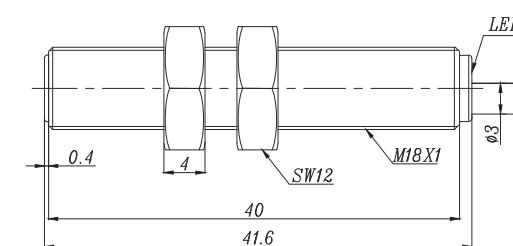
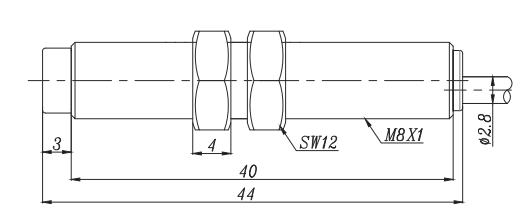

Fig.2



C+R Automations- GmbH
Nürnberger Straße 45
90513 Zirndorf

Tel. +49 (0)911 656587-0
E-Mail: info@crautomation.de
www.crautomation.de

High temperature sensor-KM12



- ◆ Stainless steel housing
- ◆ Threaded cylindrical housing
- ◆ Temperature-resistant up to 120°C
- ◆ IP67
- ◆ High-brightness LED indicator

Technical Data

Type	Rated Operating Distance Sn	Mounting	Output	Voltage Range U _B	Rated Current	Switching Frequency	Ambient Temperature	Connection	Fig
Fi2-KM12-OD6L/T120	2mm	Flush	DC NO	10...30VDC	≤100mA	1000Hz	-25...120°C	2m cable	Fig.1
Fi2-KM12-CD6L/T120	2mm	Flush	DC NC	10...30VDC	≤100mA	1000Hz	-25...120°C	2m cable	Fig.1
Ni4-KM12-OD6L/T120	4mm	Non-flush	DC NO	10...30VDC	≤100mA	800Hz	-25...120°C	2m cable	Fig.2
Ni4-KM12-CD6L/T120	4mm	Non-flush	DC NC	10...30VDC	≤100mA	800Hz	-25...120°C	2m cable	Fig.2
Fi2-KM12-OP6L/T120	2mm	Flush	PNP NO	10...30VDC	≤100mA	1000Hz	-25...120°C	2m cable	Fig.1
Fi2-KM12-CP6L/T120	2mm	Flush	PNP NC	10...30VDC	≤100mA	1000Hz	-25...120°C	2m cable	Fig.1
Fi2-KM12-ON6L/T120	2mm	Flush	NPN NO	10...30VDC	≤100mA	1000Hz	-25...120°C	2m cable	Fig.1
Fi2-KM12-CN6L/T120	2mm	Flush	NPN NC	10...30VDC	≤100mA	1000Hz	-25...120°C	2m cable	Fig.1
Ni4-KM12-OP6L/T120	4mm	Non-flush	PNP NO	10...30VDC	≤100mA	800Hz	-25...120°C	2m cable	Fig.2
Ni4-KM12-CP6L/T120	4mm	Non-flush	PNP NC	10...30VDC	≤100mA	800Hz	-25...120°C	2m cable	Fig.2
Ni4-KM12-ON6L/T120	4mm	Non-flush	NPN NO	10...30VDC	≤100mA	800Hz	-25...120°C	2m cable	Fig.2
Ni4-KM12-CN6L/T120	4mm	Non-flush	NPN NC	10...30VDC	≤100mA	800Hz	-25...120°C	2m cable	Fig.2
Fi2-KM12-BP6L/T120	2mm	Flush	PNP NO+NC	10...30VDC	≤100mA	1000Hz	-25...120°C	2m cable	Fig.1
Fi2-KM12-BN6L/T120	2mm	Flush	NPN NO+NC	10...30VDC	≤100mA	1000Hz	-25...120°C	2m cable	Fig.1
Ni4-KM12-BP6L/T120	4mm	Non-flush	PNP NO+NC	10...30VDC	≤100mA	800Hz	-25...120°C	2m cable	Fig.2
Ni4-KM12-BN6L/T120	4mm	Non-flush	NPN NO+NC	10...30VDC	≤100mA	800Hz	-25...120°C	2m cable	Fig.2
Fi2-KM12-OSA3L/T120	2mm	Flush	AC NO	20...250VAC	≤200mA	40Hz	-25...120°C	2m cable	Fig.3
Fi2-KM12-CSA3L/T120	2mm	Flush	AC NC	20...250VAC	≤200mA	40Hz	-25...120°C	2m cable	Fig.3
Ni4-KM12-OSA3L/T120	4mm	Non-flush	AC NO	20...250VAC	≤200mA	40Hz	-25...120°C	2m cable	Fig.4
Ni4-KM12-CSA3L/T120	4mm	Non-flush	AC NC	20...250VAC	≤200mA	40Hz	-25...120°C	2m cable	Fig.4
Fi2-KM12-OA41L/T120	2mm	Flush	DC/AC NO	20...250VAC/DC	DC≤100mA/ AC≤200mA	40Hz	-25...120°C	2m cable	Fig.3
Fi2-KM12-CA41L/T120	2mm	Flush	DC/AC NC	20...250VAC/DC	DC≤100mA/ AC≤200mA	40Hz	-25...120°C	2m cable	Fig.3
Ni4-KM12-OA41L/T120	4mm	Non-flush	DC/AC NO	20...250VAC/DC	DC≤100mA/ AC≤200mA	40Hz	-25...120°C	2m cable	Fig.4
Ni4-KM12-CA41L/T120	4mm	Non-flush	DC/AC NC	20...250VAC/DC	DC≤100mA/ AC≤200mA	40Hz	-25...120°C	2m cable	Fig.4

High temperature sensor-KM12

Dimensions

Fig.1

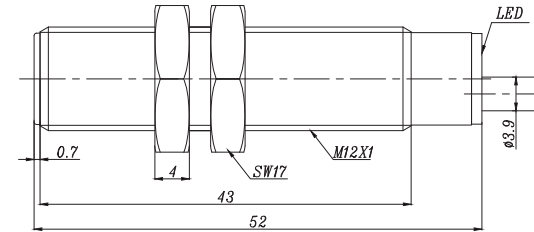

Fig.2

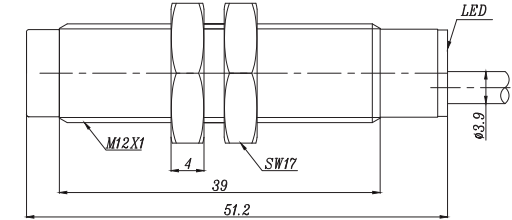

Fig.3

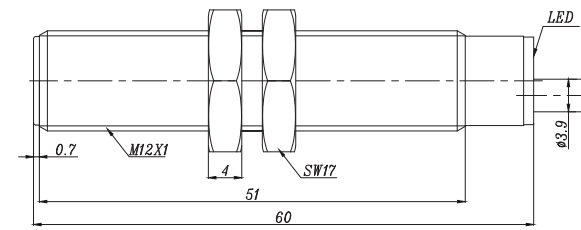
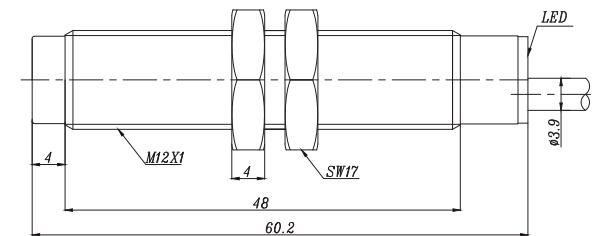

Fig.4



C+R Automations- GmbH

Nürnberg Straße 45
90513 Zirndorf

Tel. +49 (0)911 656587-0
E-Mail: info@crautomation.de
www.crautomation.de

High temperature sensor-KM12



- ◆ Stainless steel housing
- ◆ Threaded cylindrical housing
- ◆ Temperature-resistant up to 120°C
- ◆ IP67
- ◆ High-brightness LED indicator

Technical Data

Type	Rated Operating Distance Sn	Mounting	Output	Voltage Range U _B	Rated Current	Switching Frequency	Ambient Temperature	Connection	Fig
Fi2-KM12-OD6L-Q12/T120	2mm	Flush	DC NO	10...30VDC	≤100mA	1000Hz	-25...120°C	M12 Connector	Fig.1
Fi2-KM12-CD6L-Q12/T120	2mm	Flush	DC NC	10...30VDC	≤100mA	1000Hz	-25...120°C	M12 Connector	Fig.1
Ni4-KM12-OD6L-Q12/T120	4mm	Non-flush	DC NO	10...30VDC	≤100mA	800Hz	-25...120°C	M12 Connector	Fig.2
Ni4-KM12-CD6L-Q12/T120	4mm	Non-flush	DC NC	10...30VDC	≤100mA	800Hz	-25...120°C	M12 Connector	Fig.2
Fi2-KM12-OP6L-Q12/T120	2mm	Flush	PNP NO	10...30VDC	≤100mA	1000Hz	-25...120°C	M12 Connector	Fig.1
Fi2-KM12-CP6L-Q12/T120	2mm	Flush	PNP NC	10...30VDC	≤100mA	1000Hz	-25...120°C	M12 Connector	Fig.1
Fi2-KM12-ON6L-Q12/T120	2mm	Flush	NPN NO	10...30VDC	≤100mA	1000Hz	-25...120°C	M12 Connector	Fig.1
Fi2-KM12-CN6L-Q12/T120	2mm	Flush	NPN NC	10...30VDC	≤100mA	1000Hz	-25...120°C	M12 Connector	Fig.1
Ni4-KM12-OP6L-Q12/T120	4mm	Non-flush	PNP NO	10...30VDC	≤100mA	800Hz	-25...120°C	M12 Connector	Fig.2
Ni4-KM12-CP6L-Q12/T120	4mm	Non-flush	PNP NC	10...30VDC	≤100mA	800Hz	-25...120°C	M12 Connector	Fig.2
Ni4-KM12-ON6L-Q12/T120	4mm	Non-flush	NPN NO	10...30VDC	≤100mA	800Hz	-25...120°C	M12 Connector	Fig.2
Ni4-KM12-CN6L-Q12/T120	4mm	Non-flush	NPN NC	10...30VDC	≤100mA	800Hz	-25...120°C	M12 Connector	Fig.2
Fi2-KM12-BP6L-Q12/T120	2mm	Flush	PNP NO+NC	10...30VDC	≤100mA	1000Hz	-25...120°C	M12 Connector	Fig.1
Fi2-KM12-BN6L-Q12/T120	2mm	Flush	NPN NO+NC	10...30VDC	≤100mA	1000Hz	-25...120°C	M12 Connector	Fig.1
Ni4-KM12-BP6L-Q12/T120	4mm	Non-flush	PNP NO+NC	10...30VDC	≤100mA	800Hz	-25...120°C	M12 Connector	Fig.2
Ni4-KM12-BN6L-Q12/T120	4mm	Non-flush	NPN NO+NC	10...30VDC	≤100mA	800Hz	-25...120°C	M12 Connector	Fig.2
Fi2-KM12-OSA3L-Q12/T120	2mm	Flush	AC NO	20...250VAC	≤200mA	40Hz	-25...120°C	M12 Connector	Fig.3
Fi2-KM12-CSA3L-Q12/T120	2mm	Flush	AC NC	20...250VAC	≤200mA	40Hz	-25...120°C	M12 Connector	Fig.3
Ni4-KM12-OSA3L-Q12/T120	4mm	Non-flush	AC NO	20...250VAC	≤200mA	40Hz	-25...120°C	M12 Connector	Fig.4
Ni4-KM12-CSA3L-Q12/T120	4mm	Non-flush	AC NC	20...250VAC	≤200mA	40Hz	-25...120°C	M12 Connector	Fig.4
Fi2-KM12-OA41L-Q12/T120	2mm	Flush	DC/AC NO	20...250VAC/DC	DC≤100mA/ AC≤200mA	40Hz	-25...120°C	M12 Connector	Fig.3
Fi2-KM12-CA41L-Q12/T120	2mm	Flush	DC/AC NC	20...250VAC/DC	DC≤100mA/ AC≤200mA	40Hz	-25...120°C	M12 Connector	Fig.3
Ni4-KM12-OA41L-Q12/T120	4mm	Non-flush	DC/AC NO	20...250VAC/DC	DC≤100mA/ AC≤200mA	40Hz	-25...120°C	M12 Connector	Fig.4
Ni4-KM12-CA41L-Q12/T120	4mm	Non-flush	DC/AC NC	20...250VAC/DC	DC≤100mA/ AC≤200mA	40Hz	-25...120°C	M12 Connector	Fig.4

High temperature sensor-KM12

Dimensions

Fig.1

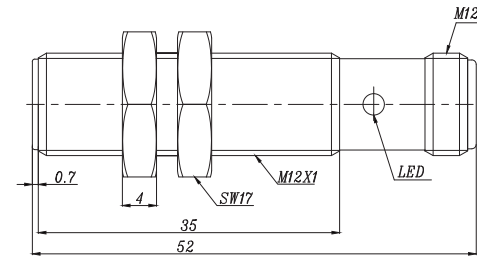

Fig.2

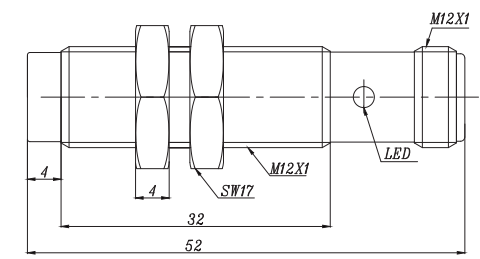

Fig.3

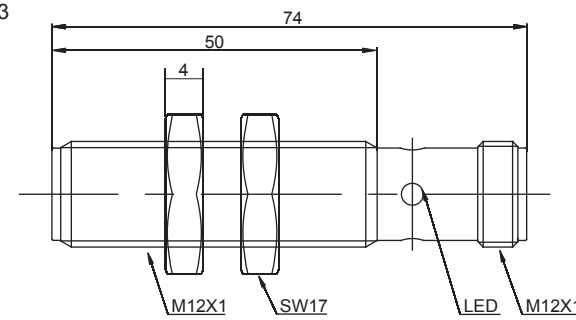
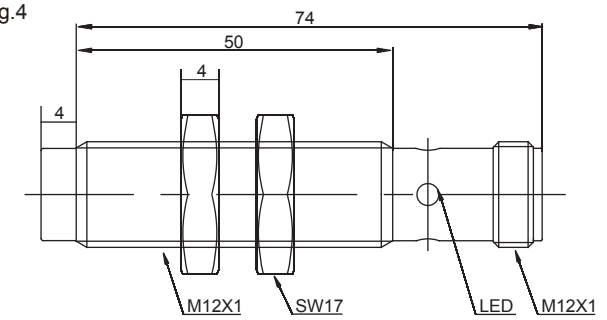

Fig.4



C+R Automations- GmbH

Nürnberg Straße 45
90513 Zirndorf

Tel. +49 (0)911 656587-0
E-Mail: info@crautomation.de
www.crautomation.de

High temperature sensor-KM18



- ◆ Stainless steel housing
- ◆ Threaded cylindrical housing
- ◆ Temperature-resistant up to 120°C
- ◆ IP67
- ◆ High-brightness LED indicator

Technical Data

Type	Rated Operating Distance Sn	Mounting	Output	Voltage Range U _B	Rated Current	Switching Frequency	Ambient Temperature	Connection	Fig
Fi5-KM18-OD6L/T120	5mm	Flush	DC NO	10...30VDC	≤100mA	800Hz	-25...120°C	2m cable	Fig.1
Fi5-KM18-CD6L/T120	5mm	Flush	DC NC	10...30VDC	≤100mA	800Hz	-25...120°C	2m cable	Fig.1
Ni8-KM18-OD6L/T120	8mm	Non-flush	DC NO	10...30VDC	≤100mA	500Hz	-25...120°C	2m cable	Fig.2
Ni8-KM18-CD6L/T120	8mm	Non-flush	DC NC	10...30VDC	≤100mA	500Hz	-25...120°C	2m cable	Fig.2
Fi5-KM18-OP6L/T120	5mm	Flush	PNP NO	10...30VDC	≤100mA	800Hz	-25...120°C	2m cable	Fig.1
Fi5-KM18-CP6L/T120	5mm	Flush	PNP NC	10...30VDC	≤100mA	800Hz	-25...120°C	2m cable	Fig.1
Fi5-KM18-ON6L/T120	5mm	Flush	NPN NO	10...30VDC	≤100mA	800Hz	-25...120°C	2m cable	Fig.1
Fi5-KM18-CN6L/T120	5mm	Flush	NPN NC	10...30VDC	≤100mA	800Hz	-25...120°C	2m cable	Fig.1
Ni8-KM18-OP6L/T120	8mm	Non-flush	PNP NO	10...30VDC	≤100mA	500Hz	-25...120°C	2m cable	Fig.2
Ni8-KM18-CP6L/T120	8mm	Non-flush	PNP NC	10...30VDC	≤100mA	500Hz	-25...120°C	2m cable	Fig.2
Ni8-KM18-ON6L/T120	8mm	Non-flush	NPN NO	10...30VDC	≤100mA	500Hz	-25...120°C	2m cable	Fig.2
Ni8-KM18-CN6L/T120	8mm	Non-flush	NPN NC	10...30VDC	≤100mA	500Hz	-25...120°C	2m cable	Fig.2
Fi5-KM18-BP6L/T120	5mm	Flush	PNP NO+NC	10...30VDC	≤100mA	800Hz	-25...120°C	2m cable	Fig.1
Fi5-KM18-BN6L/T120	5mm	Flush	NPN NO+NC	10...30VDC	≤100mA	800Hz	-25...120°C	2m cable	Fig.1
Ni8-KM18-BP6L/T120	8mm	Non-flush	PNP NO+NC	10...30VDC	≤100mA	500Hz	-25...120°C	2m cable	Fig.2
Ni8-KM18-BN6L/T120	8mm	Non-flush	NPN NO+NC	10...30VDC	≤100mA	500Hz	-25...120°C	2m cable	Fig.2
Fi5-KM18-OSA3L/T120	5mm	Flush	AC NO	20...250VAC	≤200mA	40Hz	-25...120°C	2m cable	Fig.3
Fi5-KM18-CSA3L/T120	5mm	Flush	AC NC	20...250VAC	≤200mA	40Hz	-25...120°C	2m cable	Fig.3
Ni8-KM18-OSA3L/T120	8mm	Non-flush	AC NO	20...250VAC	≤200mA	40Hz	-25...120°C	2m cable	Fig.4
Ni8-KM18-CSA3L/T120	8mm	Non-flush	AC NC	20...250VAC	≤200mA	40Hz	-25...120°C	2m cable	Fig.4
Fi5-KM18-OA41L/T120	5mm	Flush	DC/AC NO	20...250VAC/DC	DC≤100mA/ AC≤200mA	40Hz	-25...120°C	2m cable	Fig.3
Fi5-KM18-CA41L/T120	5mm	Flush	DC/AC NC	20...250VAC/DC	DC≤100mA/ AC≤200mA	40Hz	-25...120°C	2m cable	Fig.3
Ni8-KM18-OA41L/T120	8mm	Non-flush	DC/AC NO	20...250VAC/DC	DC≤100mA/ AC≤200mA	40Hz	-25...120°C	2m cable	Fig.4
Ni8-KM18-CA41L/T120	8mm	Non-flush	DC/AC NC	20...250VAC/DC	DC≤100mA/ AC≤200mA	40Hz	-25...120°C	2m cable	Fig.4

High temperature sensor-KM18

Dimensions

Fig.1

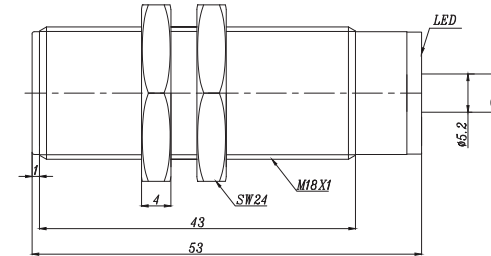

Fig.2

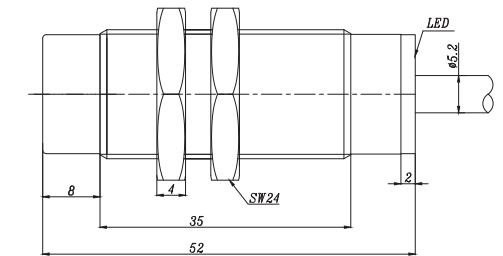

Fig.3

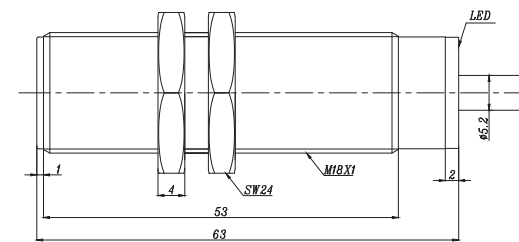
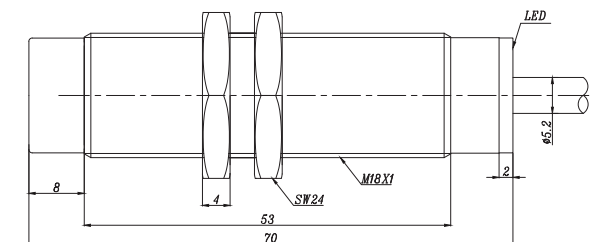

Fig.4



C+R Automations- GmbH

Nürnberg Straße 45
90513 Zirndorf

Tel. +49 (0)911 656587-0
E-Mail: info@crautomation.de
www.crautomation.de

High temperature sensor-KM18



- ◆ Stainless steel housing
- ◆ Threaded cylindrical housing
- ◆ Temperature-resistant up to 120°C
- ◆ IP67
- ◆ High-brightness LED indicator

Technical Data

Type	Rated Operating Distance Sn	Mounting	Output	Voltage Range U _B	Rated Current	Switching Frequency	Ambient Temperature	Connection	Fig
Fi5-KM18-OD6L-Q12/T120	5mm	Flush	DC NO	10...30VDC	≤100mA	800Hz	-25...120°C	M12 Connector	Fig.1
Fi5-KM18-CD6L-Q12/T120	5mm	Flush	DC NC	10...30VDC	≤100mA	800Hz	-25...120°C	M12 Connector	Fig.1
Ni8-KM18-OD6L-Q12/T120	8mm	Non-flush	DC NO	10...30VDC	≤100mA	500Hz	-25...120°C	M12 Connector	Fig.2
Ni8-KM18-CD6L-Q12/T120	8mm	Non-flush	DC NC	10...30VDC	≤100mA	500Hz	-25...120°C	M12 Connector	Fig.2
Fi5-KM18-OP6L-Q12/T120	5mm	Flush	PNP NO	10...30VDC	≤100mA	800Hz	-25...120°C	M12 Connector	Fig.1
Fi5-KM18-CP6L-Q12/T120	5mm	Flush	PNP NC	10...30VDC	≤100mA	800Hz	-25...120°C	M12 Connector	Fig.1
Fi5-KM18-ON6L-Q12/T120	5mm	Flush	NPN NO	10...30VDC	≤100mA	800Hz	-25...120°C	M12 Connector	Fig.1
Fi5-KM18-CN6L-Q12/T120	5mm	Flush	NPN NC	10...30VDC	≤100mA	800Hz	-25...120°C	M12 Connector	Fig.1
Ni8-KM18-OP6L-Q12/T120	8mm	Non-flush	PNP NO	10...30VDC	≤100mA	500Hz	-25...120°C	M12 Connector	Fig.2
Ni8-KM18-CP6L-Q12/T120	8mm	Non-flush	PNP NC	10...30VDC	≤100mA	500Hz	-25...120°C	M12 Connector	Fig.2
Ni8-KM18-ON6L-Q12/T120	8mm	Non-flush	NPN NO	10...30VDC	≤100mA	500Hz	-25...120°C	M12 Connector	Fig.2
Ni8-KM18-CN6L-Q12/T120	8mm	Non-flush	NPN NC	10...30VDC	≤100mA	500Hz	-25...120°C	M12 Connector	Fig.2
Fi5-KM18-BP6L-Q12/T120	5mm	Flush	PNP NO+NC	10...30VDC	≤100mA	800Hz	-25...120°C	M12 Connector	Fig.1
Fi5-KM18-BN6L-Q12/T120	5mm	Flush	NPN NO+NC	10...30VDC	≤100mA	800Hz	-25...120°C	M12 Connector	Fig.1
Ni8-KM18-BP6L-Q12/T120	8mm	Non-flush	PNP NO+NC	10...30VDC	≤100mA	500Hz	-25...120°C	M12 Connector	Fig.2
Ni8-KM18-BN6L-Q12/T120	8mm	Non-flush	NPN NO+NC	10...30VDC	≤100mA	500Hz	-25...120°C	M12 Connector	Fig.2
Fi5-KM18-OSA3L-Q12/T120	5mm	Flush	AC NO	20...250VAC	≤200mA	40Hz	-25...120°C	M12 Connector	Fig.3
Fi5-KM18-CSA3L-Q12/T120	5mm	Flush	AC NC	20...250VAC	≤200mA	40Hz	-25...120°C	M12 Connector	Fig.3
Ni8-KM18-OSA3L-Q12/T120	8mm	Non-flush	AC NO	20...250VAC	≤200mA	40Hz	-25...120°C	M12 Connector	Fig.4
Ni8-KM18-CSA3L-Q12/T120	8mm	Non-flush	AC NC	20...250VAC	≤200mA	40Hz	-25...120°C	M12 Connector	Fig.4
Fi5-KM18-OA41L-Q12/T120	5mm	Flush	DC/AC NO	20...250VAC/DC	DC≤100mA/ AC≤200mA	40Hz	-25...120°C	M12 Connector	Fig.3
Fi5-KM18-CA41L-Q12/T120	5mm	Flush	DC/AC NC	20...250VAC/DC	DC≤100mA/ AC≤200mA	40Hz	-25...120°C	M12 Connector	Fig.3
Ni8-KM18-OA41L-Q12/T120	8mm	Non-flush	DC/AC NO	20...250VAC/DC	DC≤100mA/ AC≤200mA	40Hz	-25...120°C	M12 Connector	Fig.4
Ni8-KM18-CA41L-Q12/T120	8mm	Non-flush	DC/AC NC	20...250VAC/DC	DC≤100mA/ AC≤200mA	40Hz	-25...120°C	M12 Connector	Fig.4

High temperature sensor-KM18

Dimensions

Fig.1

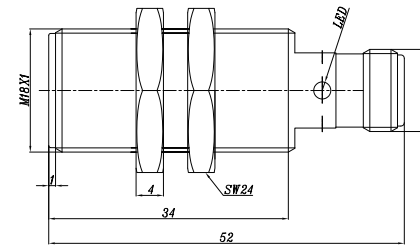

Fig.2

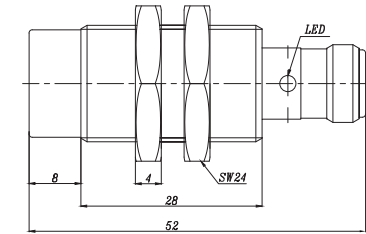

Fig.3

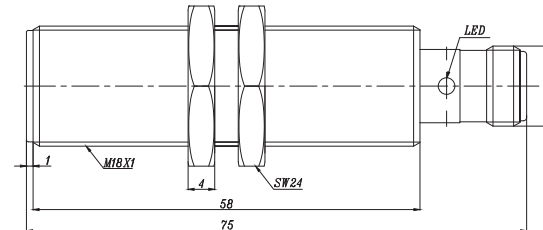
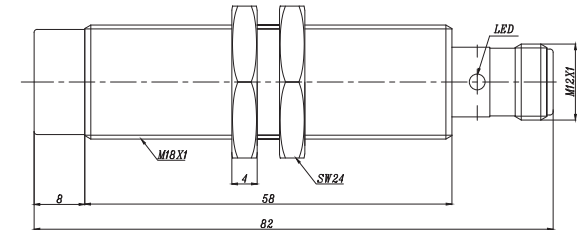

Fig.4



C+R Automations- GmbH

Nürnberger Straße 45
90513 Zirndorf

Tel. +49 (0)911 656587-0
E-Mail: info@crautomation.de
www.crautomation.de

High temperature sensor-KM30

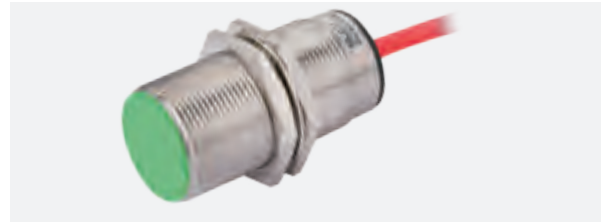

- ◆ Stainless steel housing
- ◆ Threaded cylindrical housing
- ◆ Temperature-resistant up to 120°C
- ◆ IP67
- ◆ High-brightness LED indicator

Technical Data

Type	Rated Operating Distance Sn	Mounting	Output	Voltage Range U _B	Rated Current	Switching Frequency	Ambient Temperature	Connection	Fig
Fi10-KM30-OD6L/T120	10mm	Flush	DC NO	10...30VDC	≤100mA	400Hz	-25...120°C	2m cable	Fig.1
Fi10-KM30-CD6L/T120	10mm	Flush	DC NC	10...30VDC	≤100mA	400Hz	-25...120°C	2m cable	Fig.1
Ni15-KM30-OD6L/T120	15mm	Non-flush	DC NO	10...30VDC	≤100mA	200Hz	-25...120°C	2m cable	Fig.2
Ni15-KM30-CD6L/T120	15mm	Non-flush	DC NC	10...30VDC	≤100mA	200Hz	-25...120°C	2m cable	Fig.2
Fi10-KM30-OP6L/T120	10mm	Flush	PNP NO	10...30VDC	≤100mA	400Hz	-25...120°C	2m cable	Fig.1
Fi10-KM30-CP6L/T120	10mm	Flush	PNP NC	10...30VDC	≤100mA	400Hz	-25...120°C	2m cable	Fig.1
Fi10-KM30-ON6L/T120	10mm	Flush	NPN NO	10...30VDC	≤100mA	400Hz	-25...120°C	2m cable	Fig.1
Fi10-KM30-CN6L/T120	10mm	Flush	NPN NC	10...30VDC	≤100mA	400Hz	-25...120°C	2m cable	Fig.1
Ni15-KM30-OP6L/T120	15mm	Non-flush	PNP NO	10...30VDC	≤100mA	200Hz	-25...120°C	2m cable	Fig.2
Ni15-KM30-CP6L/T120	15mm	Non-flush	PNP NC	10...30VDC	≤100mA	200Hz	-25...120°C	2m cable	Fig.2
Ni15-KM30-ON6L/T120	15mm	Non-flush	NPN NO	10...30VDC	≤100mA	200Hz	-25...120°C	2m cable	Fig.2
Ni15-KM30-CN6L/T120	15mm	Non-flush	NPN NC	10...30VDC	≤100mA	200Hz	-25...120°C	2m cable	Fig.2
Fi10-KM30-BP6L/T120	10mm	Flush	PNP NO+NC	10...30VDC	≤100mA	400Hz	-25...120°C	2m cable	Fig.1
Fi10-KM30-BN6L/T120	10mm	Flush	NPN NO+NC	10...30VDC	≤100mA	400Hz	-25...120°C	2m cable	Fig.1
Ni15-KM30-BP6L/T120	15mm	Non-flush	PNP NO+NC	10...30VDC	≤100mA	200Hz	-25...120°C	2m cable	Fig.2
Ni15-KM30-BN6L/T120	15mm	Non-flush	NPN NO+NC	10...30VDC	≤100mA	200Hz	-25...120°C	2m cable	Fig.2
Fi10-KM30-OSA3L/T120	10mm	Flush	AC NO	20...250VAC	≤200mA	40Hz	-25...120°C	2m cable	Fig.3
Fi10-KM30-CSA3L/T120	10mm	Flush	AC NC	20...250VAC	≤200mA	40Hz	-25...120°C	2m cable	Fig.3
Ni15-KM30-OSA3L/T120	15mm	Non-flush	AC NO	20...250VAC	≤200mA	40Hz	-25...120°C	2m cable	Fig.4
Ni15-KM30-CSA3L/T120	15mm	Non-flush	AC NC	20...250VAC	≤200mA	40Hz	-25...120°C	2m cable	Fig.4
Fi10-KM30-OA41L/T120	10mm	Flush	DC/AC NO	20...250VAC/DC	DC≤100mA/ AC≤200mA	40Hz	-25...120°C	2m cable	Fig.3
Fi10-KM30-CA41L/T120	10mm	Flush	DC/AC NC	20...250VAC/DC	DC≤100mA/ AC≤200mA	40Hz	-25...120°C	2m cable	Fig.3
Ni15-KM30-OA41L/T120	15mm	Non-flush	DC/AC NO	20...250VAC/DC	DC≤100mA/ AC≤200mA	40Hz	-25...120°C	2m cable	Fig.4
Ni15-KM30-CA41L/T120	15mm	Non-flush	DC/AC NC	20...250VAC/DC	DC≤100mA/ AC≤200mA	40Hz	-25...120°C	2m cable	Fig.4

High temperature sensor-KM30

Dimensions

Fig.1

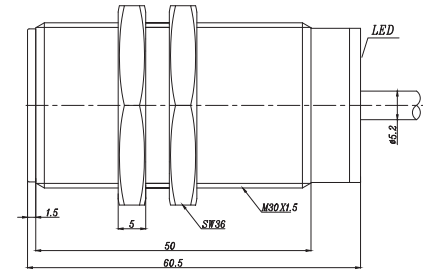

Fig.2

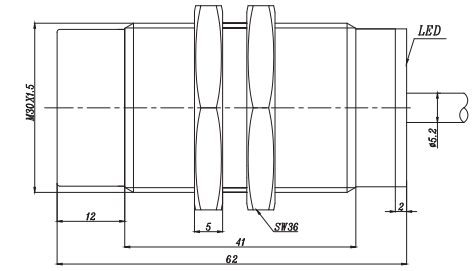

Fig.3

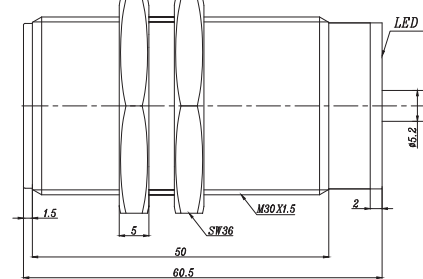
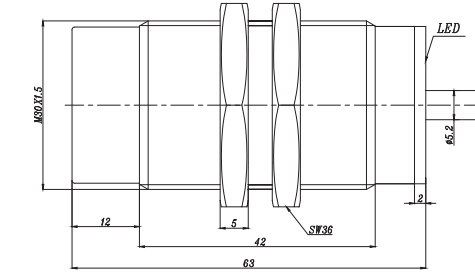

Fig.4



C+R Automations- GmbH
 Nürnberger Straße 45
 90513 Zirndorf

Tel. +49 (0)911 656587-0
 E-Mail: info@crautomation.de
 www.crautomation.de

High temperature sensor-KM30



- ◆ Stainless steel housing
- ◆ Threaded cylindrical housing
- ◆ Temperature-resistant up to 120°C
- ◆ IP67
- ◆ High-brightness LED indicator

Technical Data

Type	Rated Operating Distance Sn	Mounting	Output	Voltage Range U _B	Rated Current	Switching Frequency	Ambient Temperature	Connection	Fig
Fi10-KM30-OD6L-Q12/T120	10mm	Flush	DC NO	10...30VDC	≤100mA	400Hz	-25...120°C	M12 Connector	Fig.1
Fi10-KM30-CD6L-Q12/T120	10mm	Flush	DC NC	10...30VDC	≤100mA	400Hz	-25...120°C	M12 Connector	Fig.1
Ni15-KM30-OD6L-Q12/T120	15mm	Non-flush	DC NO	10...30VDC	≤100mA	200Hz	-25...120°C	M12 Connector	Fig.2
Ni15-KM30-CD6L-Q12/T120	15mm	Non-flush	DC NC	10...30VDC	≤100mA	200Hz	-25...120°C	M12 Connector	Fig.2
Fi10-KM30-OP6L-Q12/T120	10mm	Flush	PNP NO	10...30VDC	≤100mA	400Hz	-25...120°C	M12 Connector	Fig.1
Fi10-KM30-CP6L-Q12/T120	10mm	Flush	PNP NC	10...30VDC	≤100mA	400Hz	-25...120°C	M12 Connector	Fig.1
Fi10-KM30-ON6L-Q12/T120	10mm	Flush	NPN NO	10...30VDC	≤100mA	400Hz	-25...120°C	M12 Connector	Fig.1
Fi10-KM30-CN6L-Q12/T120	10mm	Flush	NPN NC	10...30VDC	≤100mA	400Hz	-25...120°C	M12 Connector	Fig.1
Ni15-KM30-OP6L-Q12/T120	15mm	Non-flush	PNP NO	10...30VDC	≤100mA	200Hz	-25...120°C	M12 Connector	Fig.2
Ni15-KM30-CP6L-Q12/T120	15mm	Non-flush	PNP NC	10...30VDC	≤100mA	200Hz	-25...120°C	M12 Connector	Fig.2
Ni15-KM30-ON6L-Q12/T120	15mm	Non-flush	NPN NO	10...30VDC	≤100mA	200Hz	-25...120°C	M12 Connector	Fig.2
Ni15-KM30-CN6L-Q12/T120	15mm	Non-flush	NPN NC	10...30VDC	≤100mA	200Hz	-25...120°C	M12 Connector	Fig.2
Fi10-KM30-BP6L-Q12/T120	10mm	Flush	PNP NO+NC	10...30VDC	≤100mA	400Hz	-25...120°C	M12 Connector	Fig.1
Fi10-KM30-BN6L-Q12/T120	10mm	Flush	NPN NO+NC	10...30VDC	≤100mA	400Hz	-25...120°C	M12 Connector	Fig.1
Ni15-KM30-BP6L-Q12/T120	15mm	Non-flush	PNP NO+NC	10...30VDC	≤100mA	200Hz	-25...120°C	M12 Connector	Fig.2
Ni15-KM30-BN6L-Q12/T120	15mm	Non-flush	NPN NO+NC	10...30VDC	≤100mA	200Hz	-25...120°C	M12 Connector	Fig.2
Fi10-KM30-OSA3L-Q12/T120	10mm	Flush	AC NO	20...250VAC	≤200mA	40Hz	-25...120°C	M12 Connector	Fig.3
Fi10-KM30-CSA3L-Q12/T120	10mm	Flush	AC NC	20...250VAC	≤200mA	40Hz	-25...120°C	M12 Connector	Fig.3
Ni15-KM30-OSA3L-Q12/T120	15mm	Non-flush	AC NO	20...250VAC	≤200mA	40Hz	-25...120°C	M12 Connector	Fig.4
Ni15-KM30-CSA3L-Q12/T120	15mm	Non-flush	AC NC	20...250VAC	≤200mA	40Hz	-25...120°C	M12 Connector	Fig.4
Fi10-KM30-OA41L-Q12/T120	10mm	Flush	DC/AC NO	20...250VAC/DC	DC≤100mA/ AC≤200mA	40Hz	-25...120°C	M12 Connector	Fig.3
Fi10-KM30-CA41L-Q12/T120	10mm	Flush	DC/AC NC	20...250VAC/DC	DC≤100mA/ AC≤200mA	40Hz	-25...120°C	M12 Connector	Fig.3
Ni15-KM30-OA41L-Q12/T120	15mm	Non-flush	DC/AC NO	20...250VAC/DC	DC≤100mA/ AC≤200mA	40Hz	-25...120°C	M12 Connector	Fig.4
Ni15-KM30-CA41L-Q12/T120	15mm	Non-flush	DC/AC NC	20...250VAC/DC	DC≤100mA/ AC≤200mA	40Hz	-25...120°C	M12 Connector	Fig.4

High temperature sensor-KM30

Dimensions

Fig.1

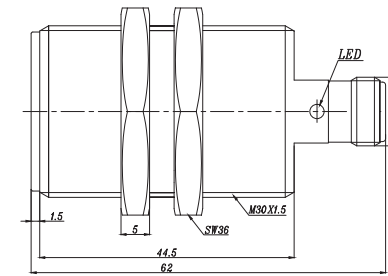

Fig.2

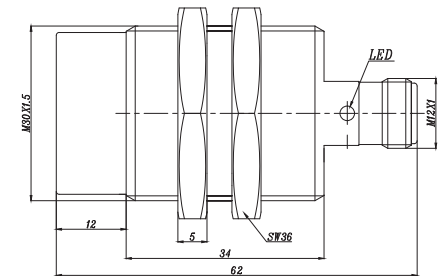

Fig.3

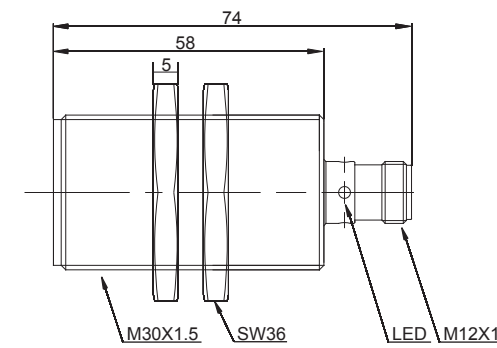
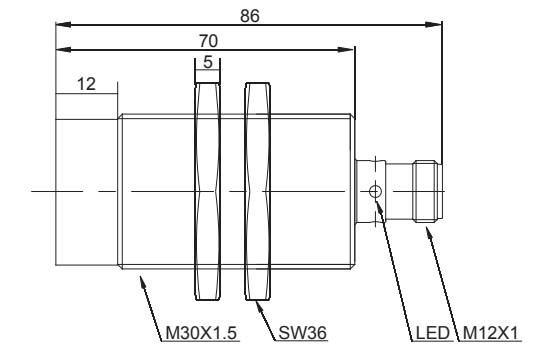

Fig.4



C+R Automations- GmbH
 Nürnberger Straße 45
 90513 Zirndorf

Tel. +49 (0)911 656587-0
 E-Mail: info@crautomation.de
 www.crautomation.de